

Replacing the Toner Cartridge on the PagePro 1250E/1200W/1250W

Two toner cartridges are available ... the actual number of pages obtained from a toner cartridge depends on the image density of the pages you print:

- The **high-capacity toner cartridge** has a capacity of about 6000 letter/A4 pages at about 5% toner coverage (and can be distinguished from the regular toner cartridge by the 'PS HI' notation embedded on the toner by the green handle).

Note The toner cartridge that comes with the printer has a capacity of about 1500 letter/A4 pages at about 5% toner coverage.

Note If printed images start to get light, remove the toner cartridge from the printer, rock it back and forth a few times, and then replace it in the printer. If this does not solve the problem, you likely need to replace the toner cartridge with a new one.

Caution **You could damage the unit by using incorrect accessories and parts!** If you use accessories and parts from manufacturers other than manufactured by us, we cannot guarantee that the laser printer will operate properly. Use only accessories and parts manufactured by us unless specified otherwise.

Replacing the Toner Cartridge

Warning **The fusing unit can become very hot!** The fusing unit, which is located beneath the top cover, can become very hot when the printer is in operation. To prevent injuries, avoid contact with this area.

PagePro 1250E	PagePro 1200W
---------------	---------------

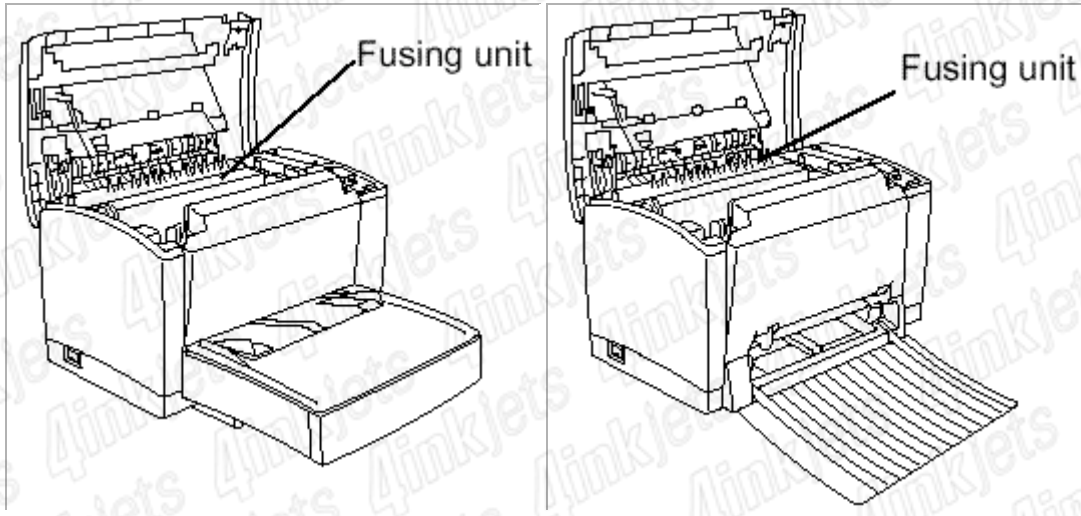

Caution Never touch the developing roller under the flap; otherwise, print quality may decline.

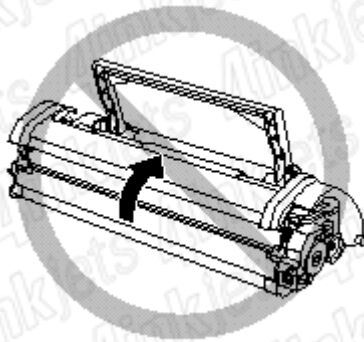

1. Turn off the printer and disconnect the power cord from the printer.
2. Close the face-down tray.
3. Press the top cover release button and open the top cover.

PagePro 1250E

PagePro 1200W/1250W

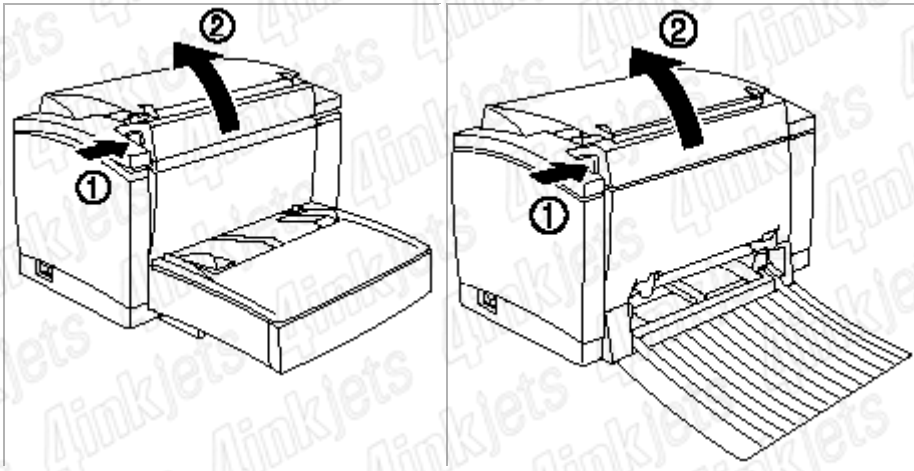

4. Remove the old toner cartridge.

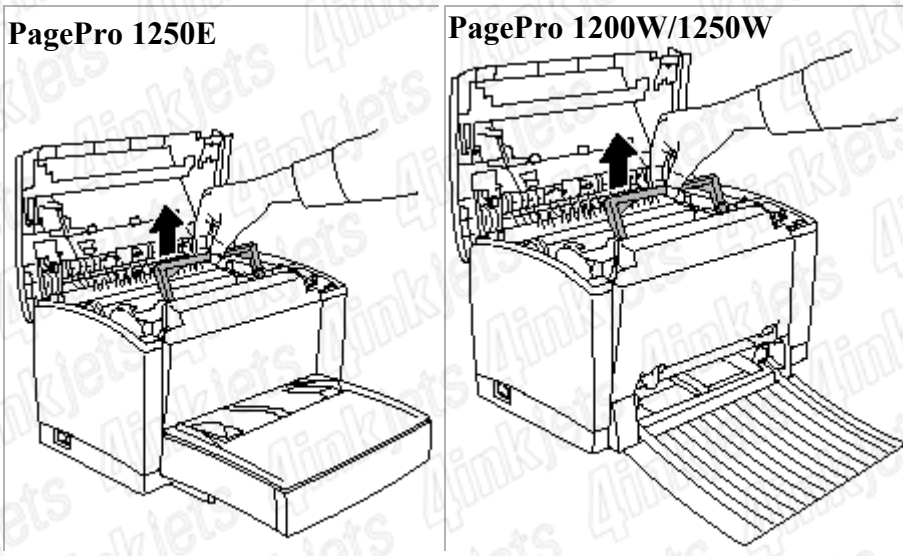

5. Press in the marked positions of the handle to fold down the handle. Dispose of the used toner cartridge properly.

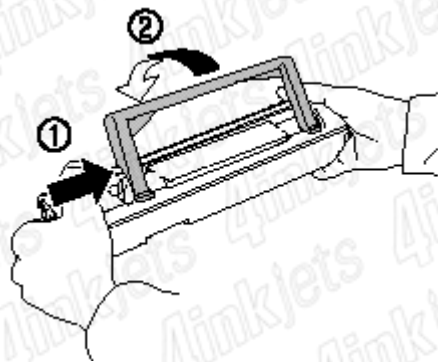

6. Remove the new toner cartridge from its package.
7. Holding it firmly with both hands, rock the toner cartridge left and right, forward and backward, to distribute the toner evenly.

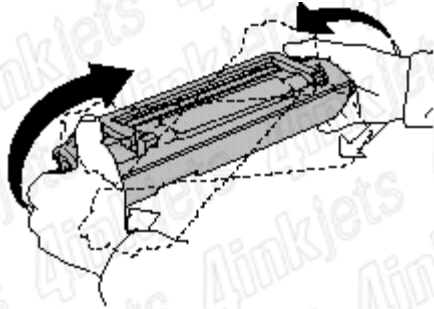

8. Completely remove the protective seal from the toner cartridge, and then raise up the handle.

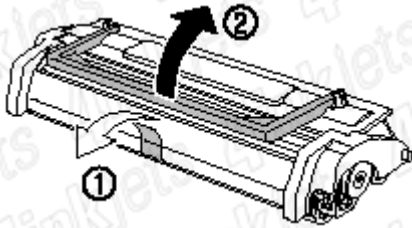

9. Holding the handle, lower the toner cartridge into the printer, aligning the four pins (two on each side) with the grooves inside the printer. Color coordinated '2' labels have been affixed to the toner cartridge and to the inside of the printer. Install the toner cartridge by aligning these labels.

PagePro 1250E

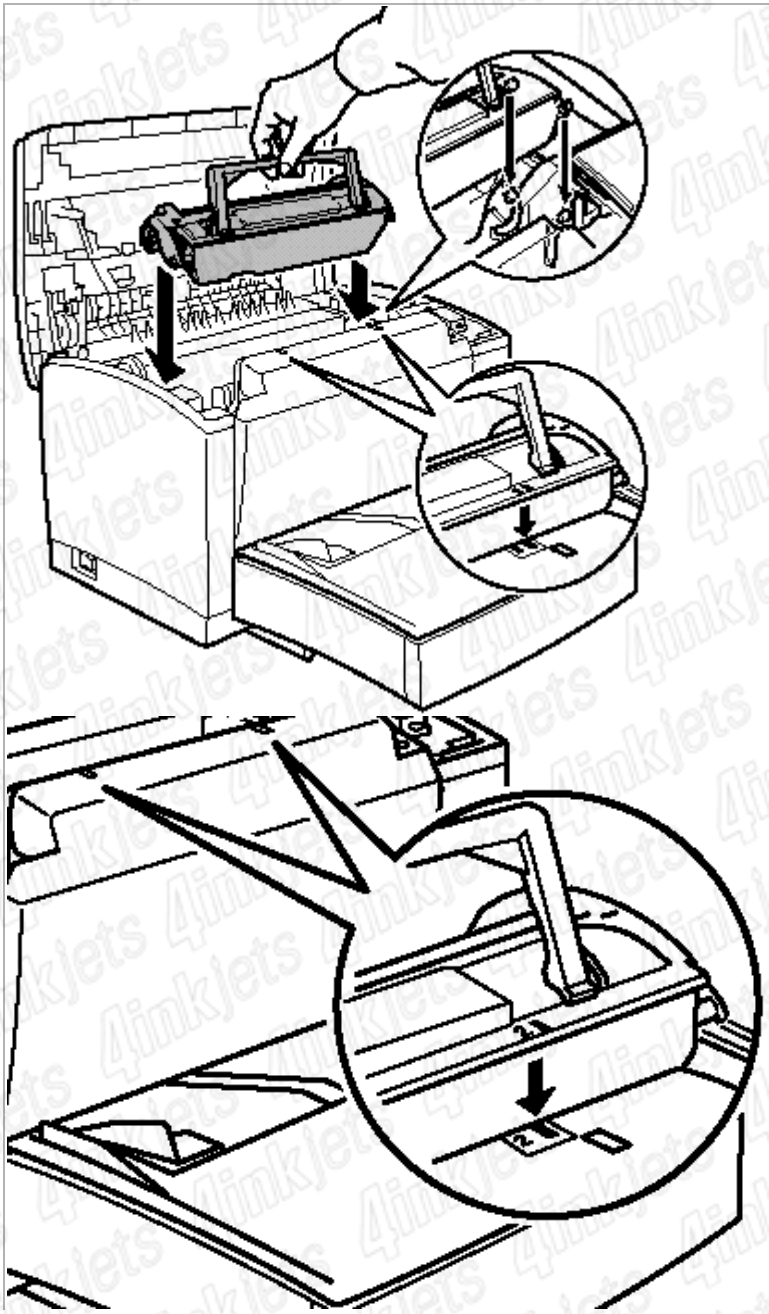

PagePro 1200W/1250W

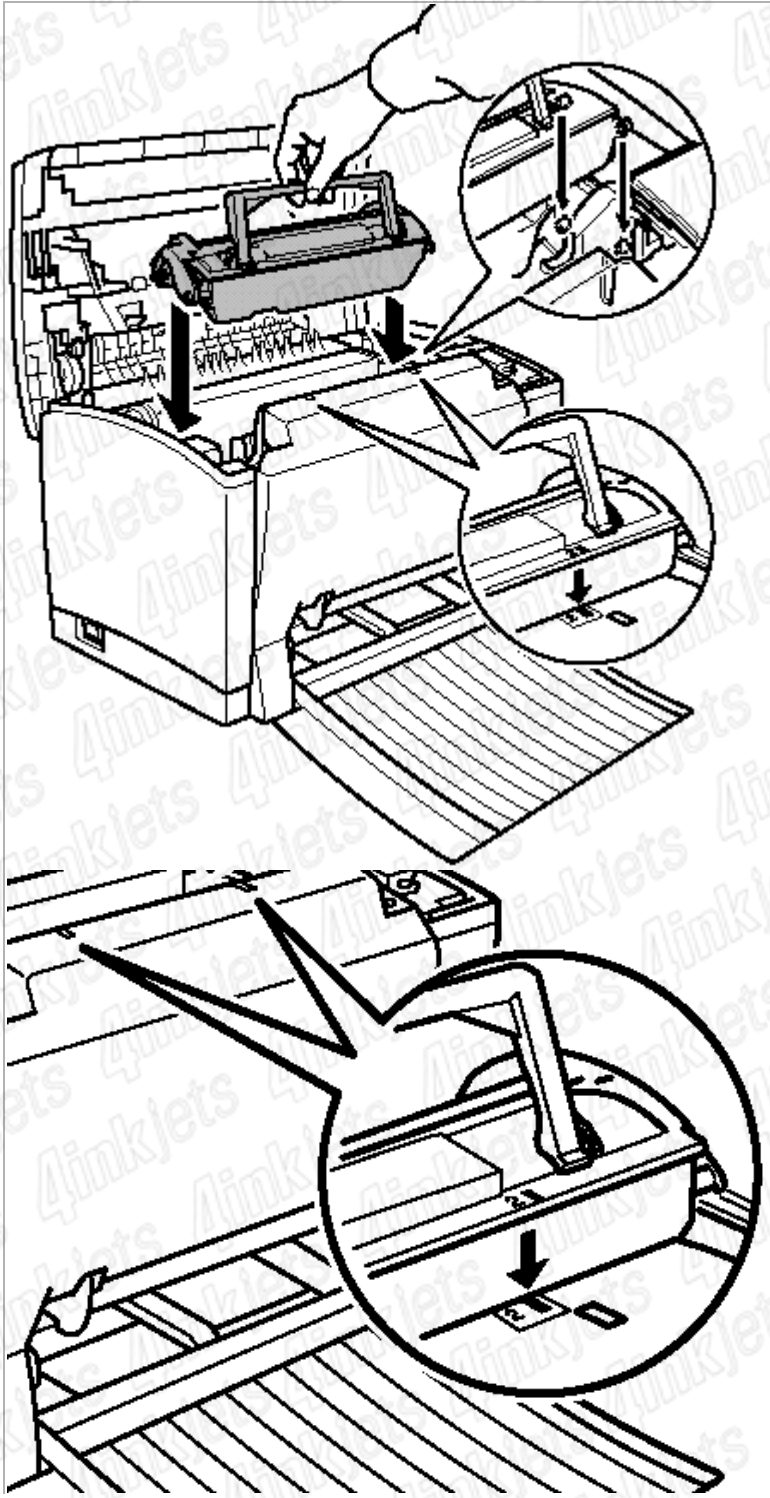

The toner cartridge clicks into place when it is completely installed.

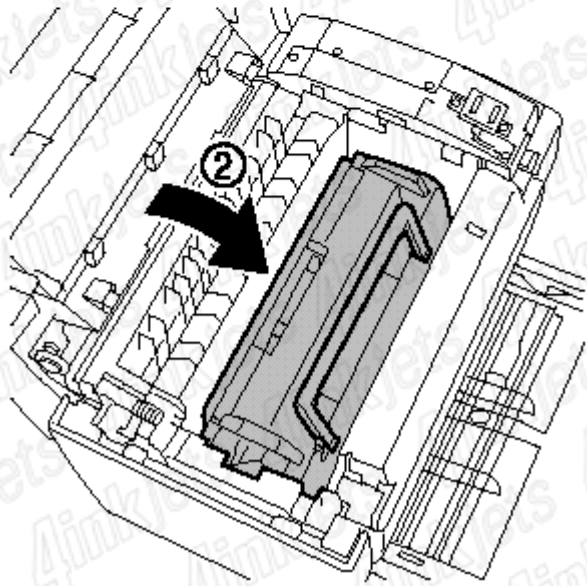
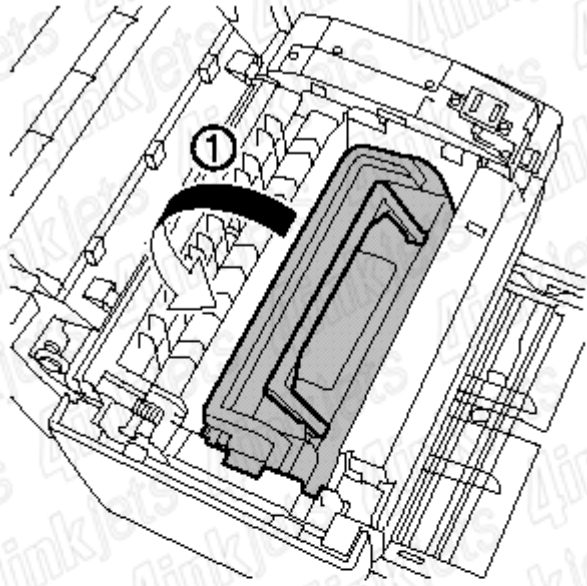

10. Close the top cover and press it down gently but firmly until it locks into place.

PagePro 1250E

PagePro 1200W/1250W

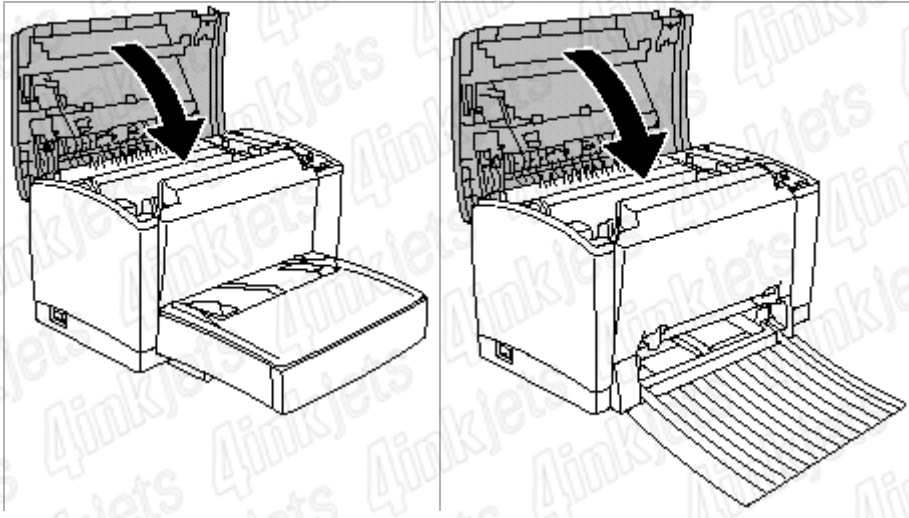

Resetting the Counters

Using the printer buttons

1. Turn off the printer.
2. While holding down the panel button, turn on the printer. The green 'Ready' indicator begins to blink.
3. Continue holding down the panel button, and the green 'Ready' indicator starts to blink.
4. After the green 'Ready' indicator has blinked for about 5 seconds, release the panel button. Both indicators begin to blink.
5. After confirming that both indicators are blinking, press and hold down the panel button again for at least 5 seconds or more (for the toner cartridge) or less than 5 seconds (for the drum counter). Both indicators light up for about 5 seconds, and then both indicators begin to blink again.
6. Turn the printer off and then on again. Once the green 'Ready' indicator remains on, the printer is again in Stand-by mode.